

GLENWOOD Ranch

Living Area 103 m²
Deck 21.5 m



HOEK MODULAR HOMES

PO BOX 70 PETRIE QLD 4502 Phone: 3889 7385 Fax: 3889 7386

BSA LICENCE NO : 1169 135 Email: sales@hoekmodularhomes.com

Kitchens & Windows may vary in Quote Plans



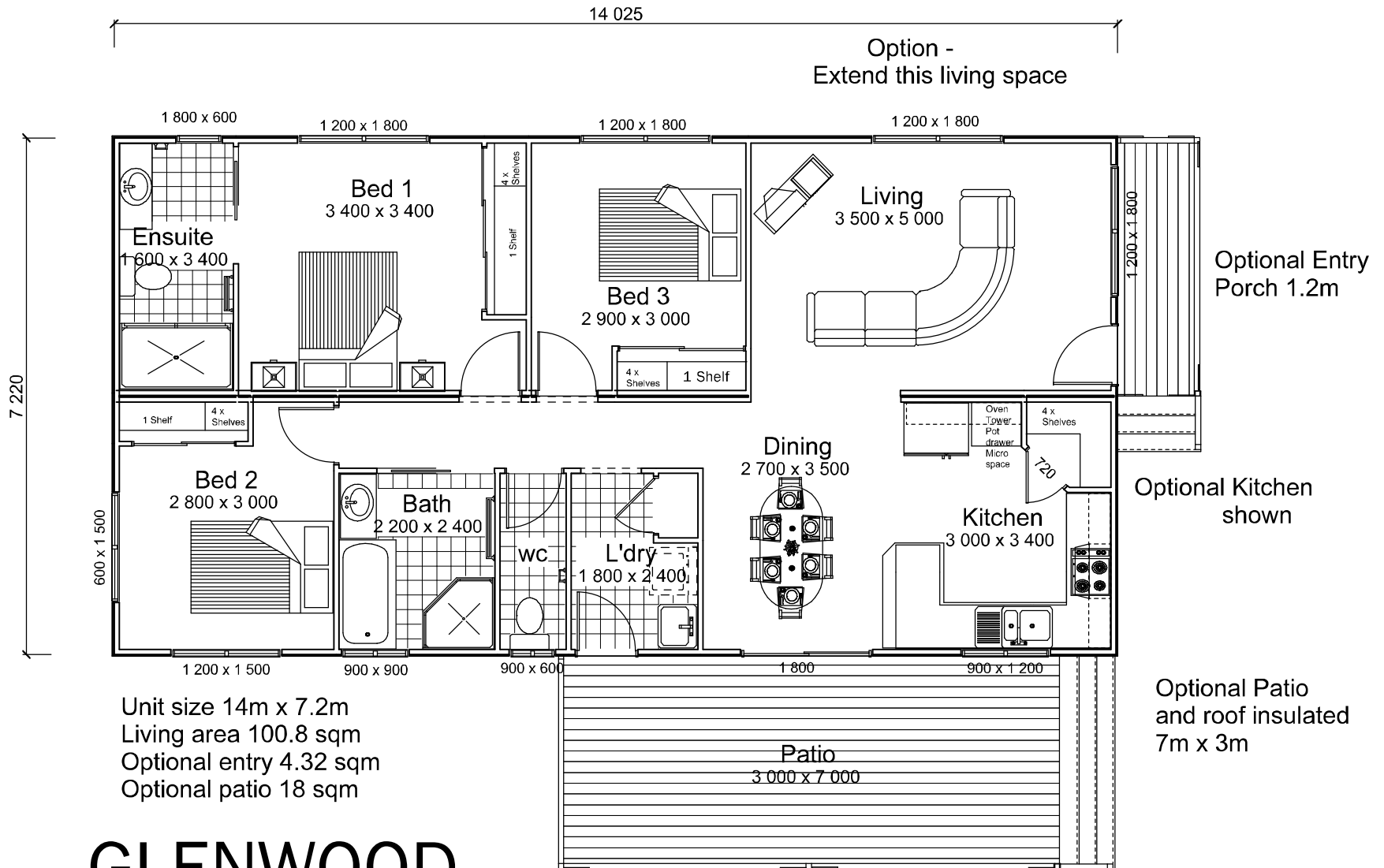

GLENWOOD

ensuite V1

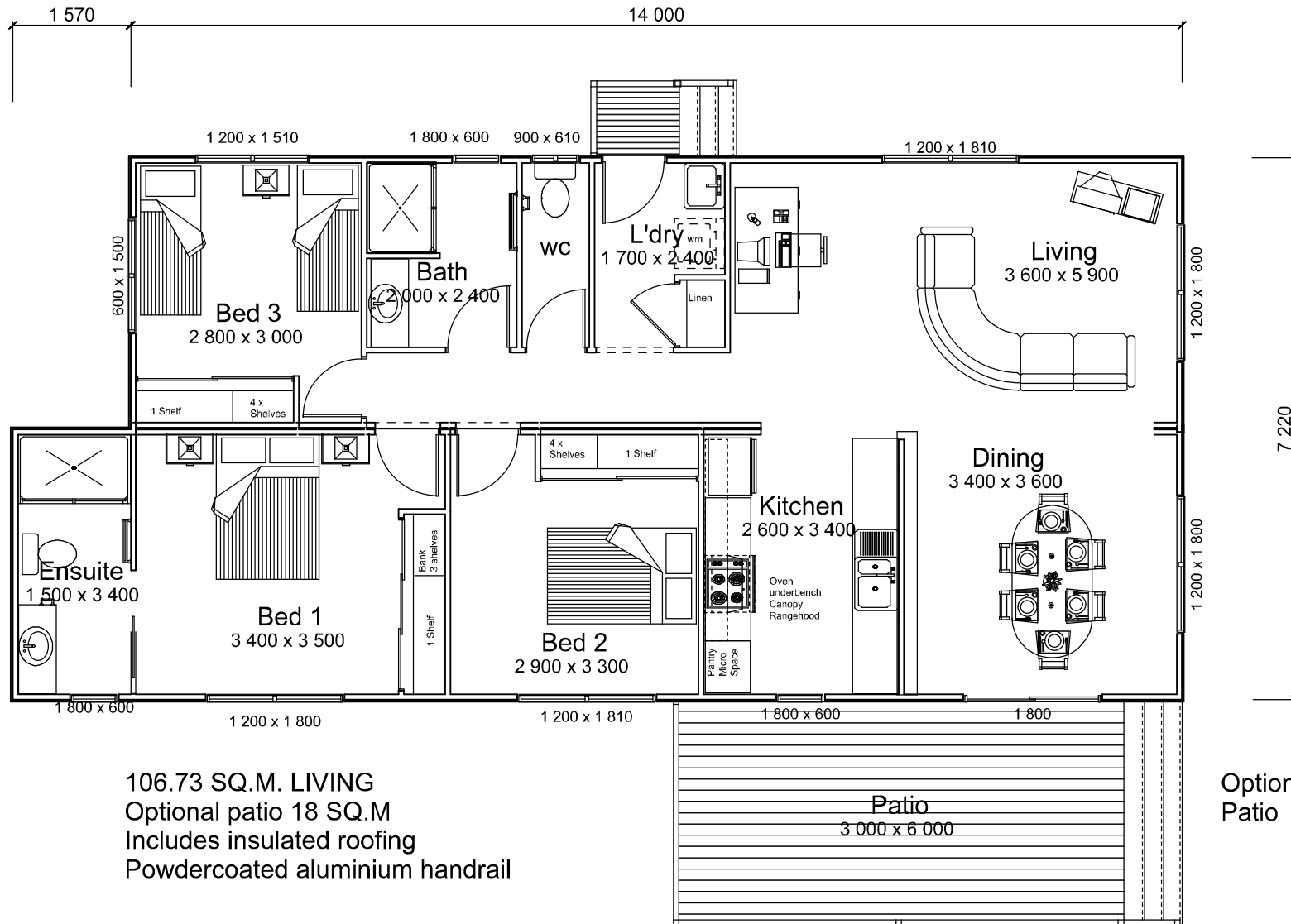

GLENWOOD

ensuite V2

Unit size 14/15.57m x 7.2m



HOEK MODULAR HOMES

PO BOX 70 PETRIE QLD 4502 Phone: 3889 7385 Fax: 3889 7386

BSA LICENCE NO : 1169 135 Email: sales@hoekmodularhomes.com

Kitchens & Windows may vary in Quote Plans



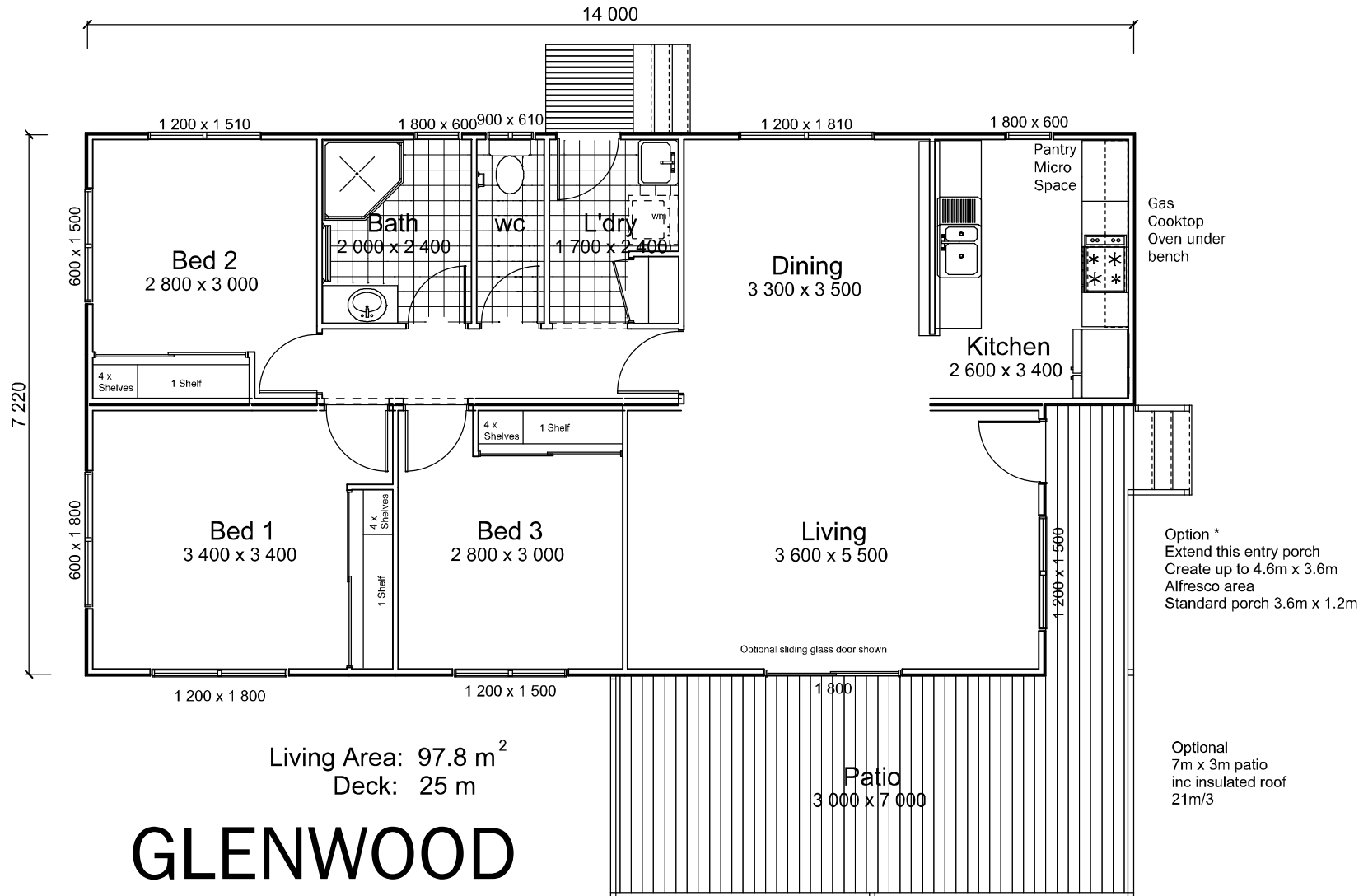

HOEK MODULAR HOMES

PO BOX 70 PETRIE QLD 4502 Phone: 3889 7385 Fax: 3889 7386

BSA LICENCE NO : 1169 135 Email: sales@hoekmodularhomes.com

Kitchens & Windows may vary in Quote Plans

