

Optional Patio
extended 2m

Optional Kitchen Shown

Living Area : 101 m²
Patio 12 m

Jasper

Unit Size 15m x 7.2m



Kitchens & Windows may
vary in Quote Plans

HOEK MODULAR HOMES

PO BOX 70 PETRIE QLD 4502 Phone: 3889 7385 Fax: 3889 7386

BSA LICENCE NO : 1169 135 Email: sales@hoekmodularhomes.com



Optional Kitchen Shown

15 000

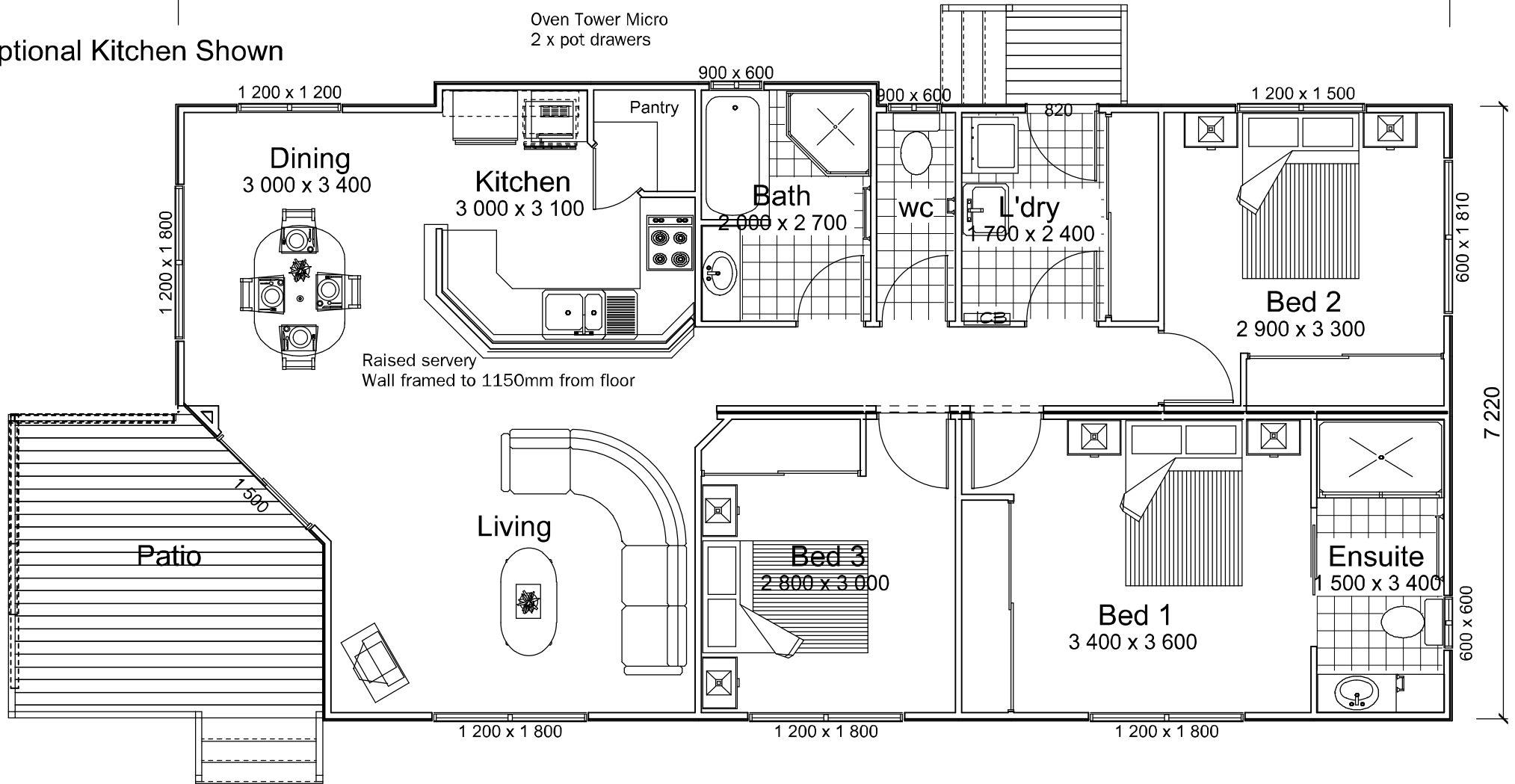

Optional Patio
extended 2m

Jasper V2

Unit size 15m x 7.2m

Living Area : 105.7 m²
Deck 12 m



Kitchens & Windows may
vary in Quote Plans

HOEK MODULAR HOMES

PO BOX 70 PETRIE QLD 4502 Phone: 3889 7385 Fax: 3889 7386

BSA LICENCE NO : 1169 135 Email: sales@hoekmodularhomes.com



